

Soils Map-CSR2

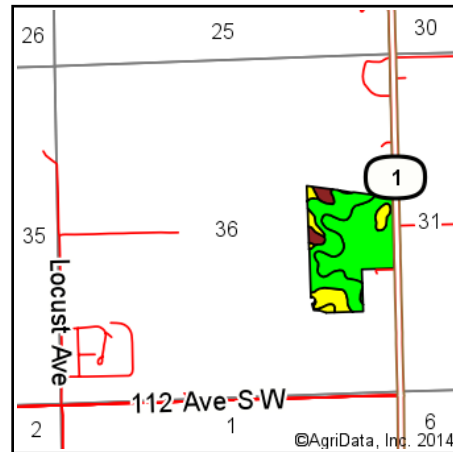

State: **Iowa**
 County: **Jefferson**
 Location: **36-71N-10W**
 Township: **Liberty**
 Acres: **49.92**
 Date: **10/3/2014**

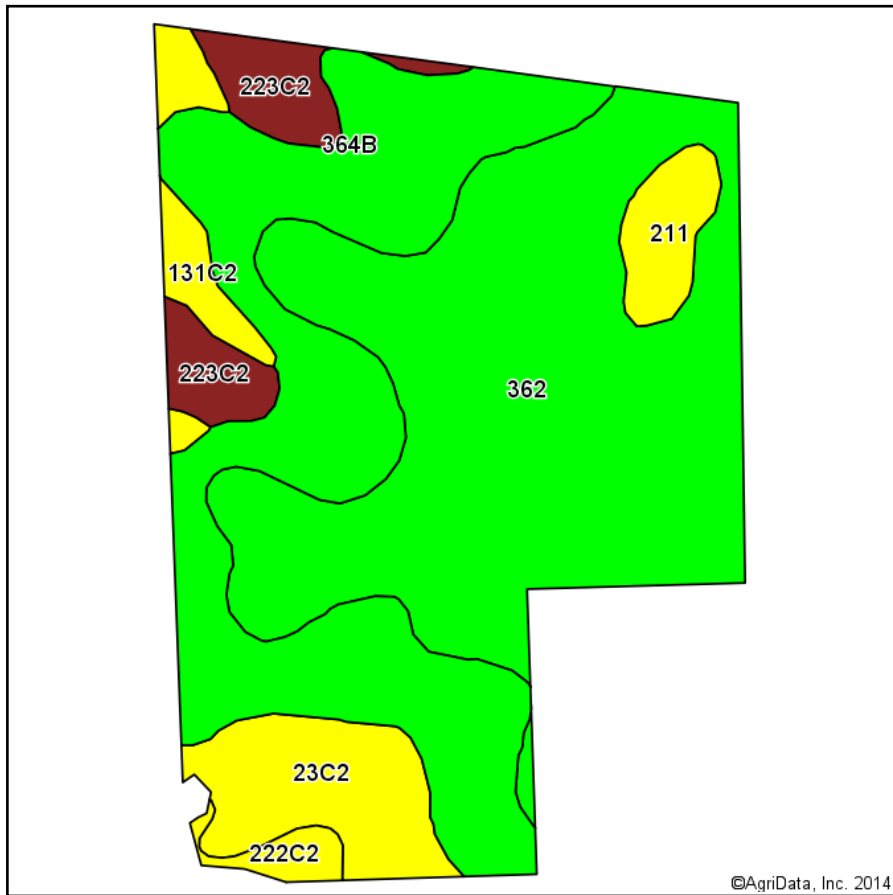
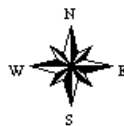

Maps Provided By:

 CUSTOMIZED ONLINE MAPPING
 © AgriData, Inc. 2014 www.AgriDataInc.com

Area Symbol: IA101, Soil Area Version: 21

Code	Soil Description	Acres	Percent of field	**CSR2 Legend	Non-Irr Class	CSR2**	CSR	Corn	Soybeans
362	Haig silt loam, 0 to 2 percent slopes	23.34	46.8%		IIw	82	70		
364B	Grundy silty clay loam, 2 to 5 percent slopes	16.28	32.6%		Ile	75	75		
23C2	Arispe silty clay loam, 5 to 9 percent slopes, moderately eroded	4.00	8.0%		IIIe	60	50	9	3
223C2	Rinda silty clay loam, 5 to 9 percent slopes, moderately eroded	2.64	5.3%		IVw	34	22		
131C2	Pershing silty clay loam, 5 to 9 percent slopes, moderately eroded	1.51	3.0%		IIIe	60	45		
211	Edina silt loam, depressional, 0 to 1 percent slopes	1.50	3.0%		IIIw	58	55		
222C2	Clarinda silty clay loam, 5 to 9 percent slopes, moderately eroded	0.65	1.3%		IVw	42	25		
Weighted Average						73.5	65.7	0.7	0.2

Area Symbol: IA101, Soil Area Version: 21

**IA has updated the CSR values for each county to CSR2.

Field borders provided by Farm Service Agency as of 5/21/2008. Aerial photography provided by Aerial Photography Field Office.